

REF. or DRAWING No. **NEP-918**

DETAILS

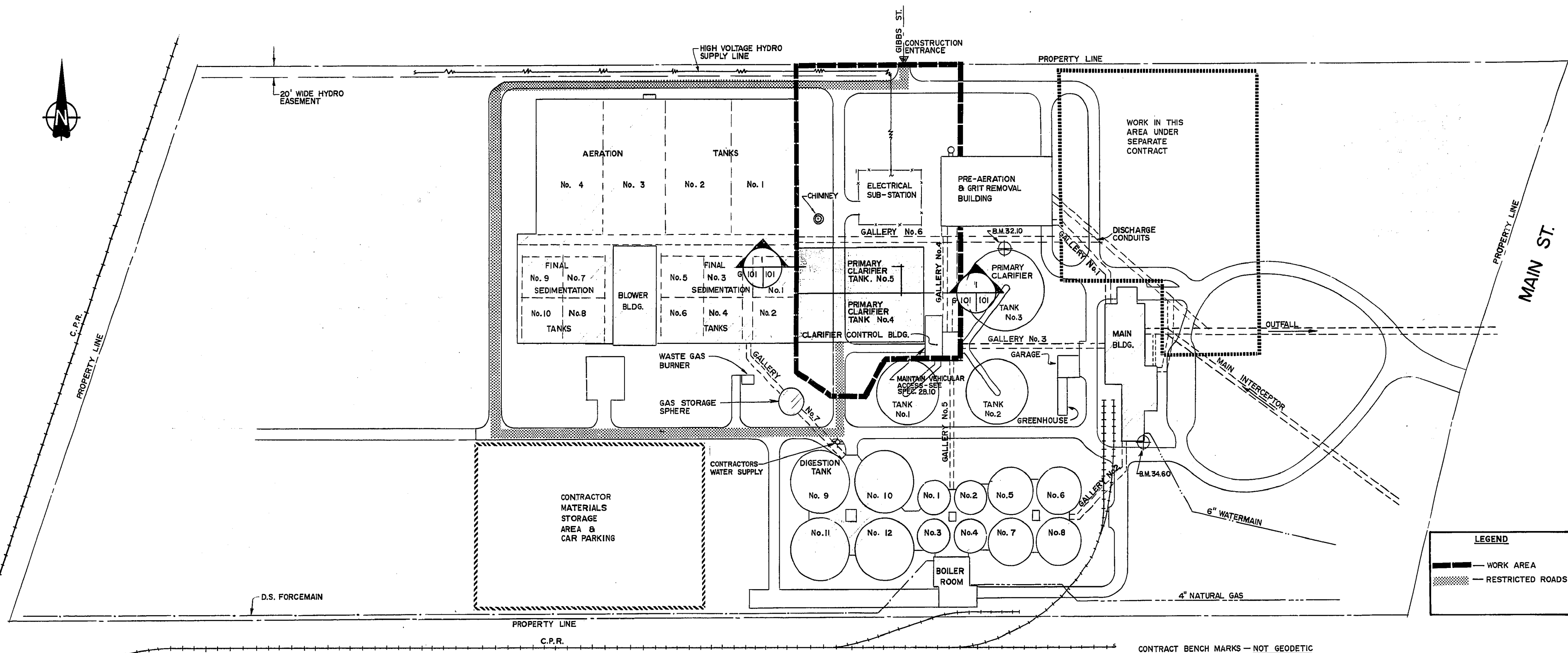

LEGEND

- WORK AREA
- RESTRICTED ROADS

SITE PLAN
SCALE: 1" = 100'

CONTRACT BENCH MARKS - NOT GEODETIC
 BM₁ - AT S.E. CORNER OF MAIN BLDG. ELEV. 34.60'
 BM₂ - AT NORTH CENTRAL TANGENT POINT OF PRIMARY CLARIFIER TANK No. 3 ELEV. 32.10'

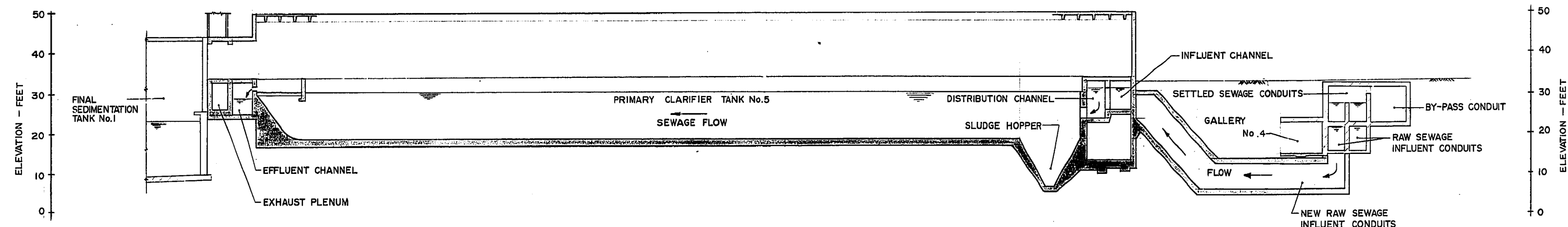

SECTION
SCALE: 1/16" = 1'-0"

NO.	DATE	DESCRIPTION

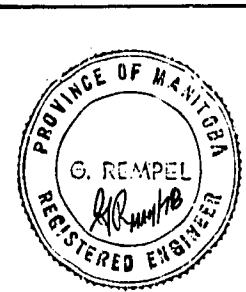

AS BUILT CSA	41	SEPT. 79
ISSUED FOR TENDER	19/5/78	CHECKED BY: [Signature]
REV.	DESCRIPTION	BY DATE

W. L. WARDROP & ASSOCIATES LTD.
JAMES F. MACLAREN LIMITED
 ENGINEERING CONSULTANTS

DRAWN BY: [Signature]
 DESIGNED BY: [Signature]
 APPROVED BY: [Signature] DATE: [Date]

THE CITY OF WINNIPEG
 WORKS & OPERATIONS DEPARTMENT
 WATERWORKS, WASTE & DISPOSAL DIVISION

NORTH END WATER POLLUTION CONTROL CENTRE
 PRIMARY CLARIFIER ADDITION

SITE PLAN

MICROFILMED MAR 31 1980

SCALE: AS SHOWN
 DATE: MAY 1978
 CONSULTANT DRAWING NO. 76012-05-G101
 CITY DRAWING NO. **NEP-918**